

KNIGHT ES
BLDG #231-B

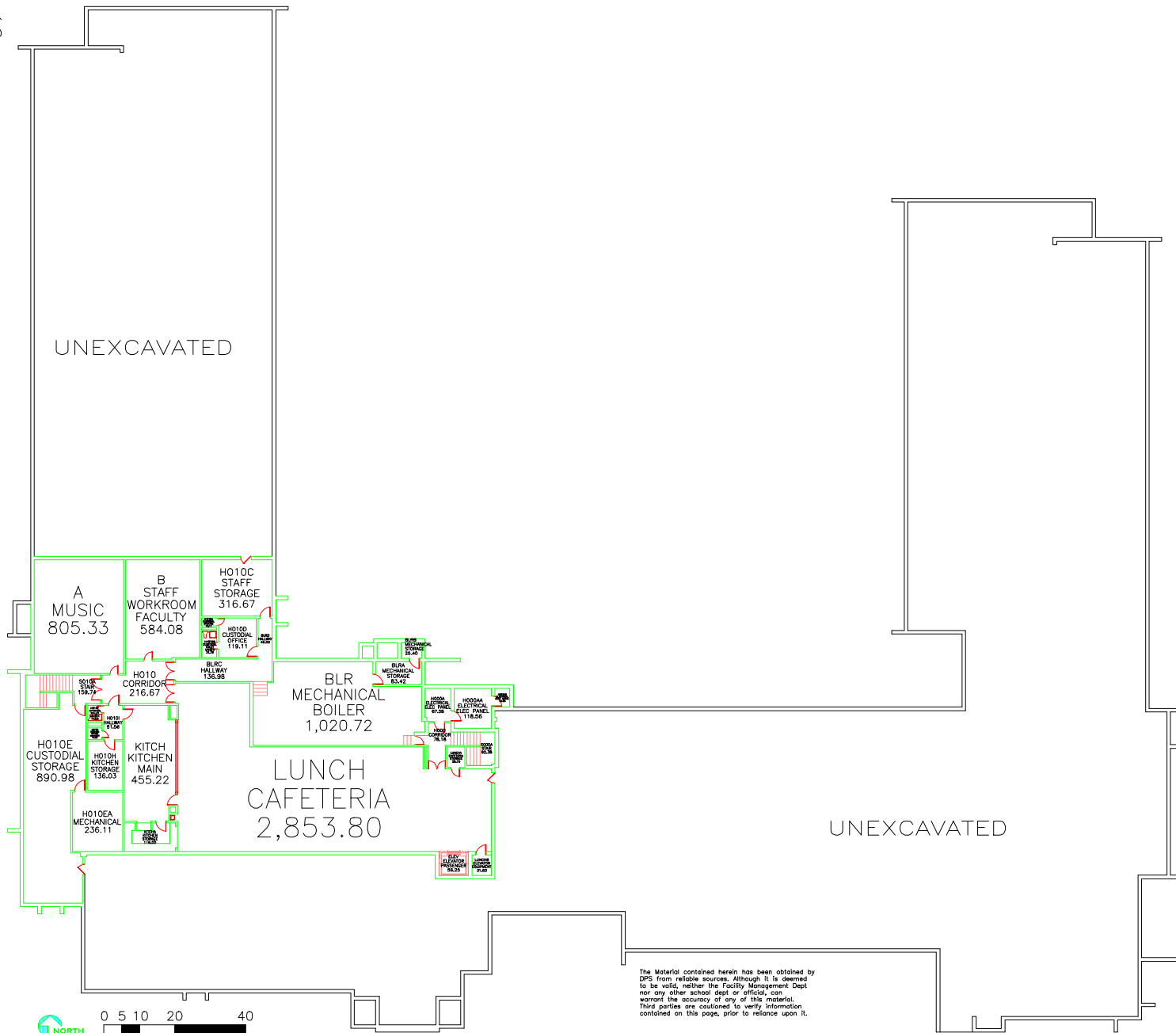

The Material contained herein has been obtained by DPS from reliable sources. Although it is deemed to be valid, neither the Facility Management Dept nor any other school dept or official, can warrant the accuracy of any of this material. Third parties are cautioned to verify information contained on this page prior to reliance upon it.

		FACILITY PLANNING DEPT. Asset Management Program KNIGHT ELEMENTARY 3245 E. EXPOSITION AVE. BASEMENT FLOOR		
		DRAWN BY DPS ARCHIVES	SCALE By scale	DWG NO. 251-B.dwg
DATE 04/2007	CHECKED DATE	SHEET 4 of 4		